

Sink into Quality Life
Style • Certified • Value





Gemini Sink Canada Inc. was incorporated under Ontario provincial in 2001 and is based in the Greater Toronto Area of Ontario, Canada.



Over the years, we have expanded rapidly in North America with a reputation for “The quality you trust” and “The Fairness you deserve”. Under our own trademark GEMINI and Cosmo, we are one of the leading specialist kitchen sinks manufacturers and wholesalers.



We have over 16 years of research, design and developmental experience which gives us the ability to release new and customized models in a short period of time. All sinks are designed in Canada and made with top quality 18 gauge (18% chrome/10% nickel content) type 304 stainless steel and certified with C/US approval. GEMINI sinks are made with a lifetime limited buyer warranty.



Our mission is to offer our premium quality products to everyday household around the world. With our carefully planned marketing strategies and pricing structure, we plan to have a distribution network covering the globe so that our products will be found in every boutique and home improvement center. By offering the finest materials and craftsmanship of our modern designed products, we will also be able to satisfy the market with a wide range of preferences.

Sink into a Quality life from

GEMINI



CONTENTS

GEMINI BRAND

Square Sink P.7



P.8					
CBSQ11	SQ1100	SQ1300			
P.9 - P.10					
SQ1500	SQ1700	SQ19D6	SQ2100	SQ2300	SQ2900
P.11 - P.12					
SQ1313	SQ1513	SQ1711	SQ1713	ZSSQ1200	
P.13 - P.14					
ZSSQ1500	ZSSQ2200	ZDSQ1212	ZDSQ1509	ZDSQ1512	
P.15 - P.16					
ZDSQ1909	CSQ21D10	CSQ23D09	CSQ2800	CSQ1414	CSQ1612
P.17 - P.18					
CBRC11	RC1100	RC1300	RC1500	RC1700	
P.19 - P.20					
RC2100	RC2300	RC2900	RC1313	RC1513	RC1711
P.21 - P.22					
RC1713	ZSRC1200	ZSRC1500	ZSRC1900	ZSRC2200	
P.23 - P.24					
ZDRC1212	ZDRC1509	ZDRC1512	ZDRC1909	CRC23D09	CRC21D10
P.25 - P.26					
CRC2800	CRC1414	CRC1515	CRC1614	CRC1612	
P.27 - P.28					
CRC16P	CRC19P	CRC21P	CX1311	CX1511	CX1513
P.29					
CX1711	DM1515	DM1713P			

Apron Sink P.30



P.30					
FM2900	FM1313				
P.31 - P.32					
FM1513	FM1711	FM1713	ZFM1509	ZFM1512	ZFM2200
P.33 - P.34					
RCFM2900	RCFM1313	RCFM1513	RCFM1711	RCFM1713	
P.35					
ZRCFM1509	ZRCFM1512	ZRCFM2200			

Corner Sink P.36



P.36 - P.37		
CRC13G	AG1616	AG1616H

Laundry Sink P.38



P.38	
ZSRC21D13	RCT21D13

GE Series P.39

UNDERMOUNT DOUBLE BOWL

P.40		
GE202	GE216	GE303



GE Series Cont.

P.41 - P.42					
GE301	GE301R	GE401	GE501	GE505	
P.43 - P.44					
GE605	GE601	GE601R	GE607	GE602	
P.45 - P.46					
GE602R	GE608	GE701	GE701R	GE707	GE801
P.47 TRIPLE BOWL SINK					
GE503	GE661466	KM721472			

KM Series P.48

UNDERMOUNT SINK

P.49 - P.50					
KM609	KM609R	KM1612	KM1614	KM1615	KM7272



GE Series P.51

UNDERMOUNT SINGLE BOWL

P.52					
GE101	GE102	GE103			
P.53 - P.54					
GE104	GE105	GE108	GE201	GE204	
P.55 - P.56					
GE603	GE603R	GE2518	GE702	GE703	GE803



GE Series P.57

TOPMOUNT SINK

P.58 - P.59					
T01	T02	T03	T05	T07	RNT1615



COSMO BRAND

Undermount & Topmount P.60

P.61 - P.62				
CU1820	CU3118	CU3518	CU3020	CU3320
P.63 - P.64				
CU3220	CT1515	CT2120	CT2720	CT3120



Porcelain P.65

P.65 - P.66				
W183	W210	W028	W036	W068



GEMINI BRAND

Commercial Sink P.67

P.67 - P.68					
GE002	BRRC1812	BRRC30	BRRC43		
P.69 - P.70					
BRRC54	BRRC66	FSQ30	FSQ43	FSQ54	FSQ66



Accessories P.71-P.73

More About our Sinks P.74



CBSQ11

SIZE:
13" x 15"
(330mm x 381mm)
DEPTH: 6½" (165mm)
FINISH: Satin

Optional Accessories:

GR1311

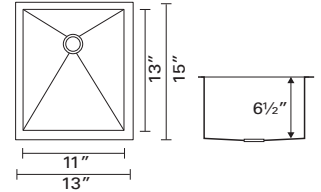

SQ1100

SIZE:
13" x 20"
(330mm x 508mm)
DEPTH: 8" (203mm)
FINISH: Satin

Optional Accessories:

GR1811SQ

BA1809

CB18

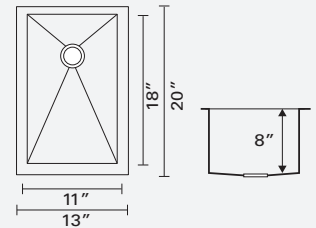
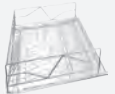

GEMINI BRANDS

SQUARE SINK

Features

- SQ sinks Zero-radius corners
- RC sinks Handcrafted 10mm radius corners
- FM sinks With integral apron

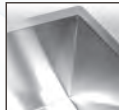

Square Corner

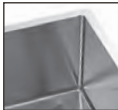

Round Corner

Installation

- Template and installation clips are packed with every sink

Standard

- All our sinks are approved with C/US certification

Warranty

- Lifetime limited buyer warranty to be free of all manufacturing defects under normal use

SQ1300

SIZE:
15" x 20"
(381mm x 508mm)
DEPTH: 10" (254mm)
FINISH: Satin

Optional Accessories:

GR1813SQ

BA1809

BA1811

CB18

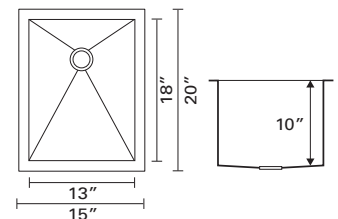

SQ1500

SIZE:

17" x 20"
(431mm x 508mm)

DEPTH: 10" (254mm)

FINISH: Satin

Optional Accessories:

GR1815SQ BA1809 BA1811 CB18

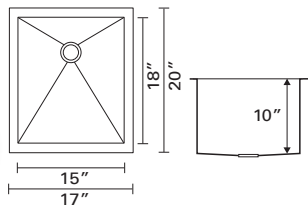

SQ2100

SIZE:

23" x 20"
(584mm x 508mm)

DEPTH: 10" (254mm)

FINISH: Satin

Optional Accessories:

GR1821SQ BA1809 BA1811 CB18

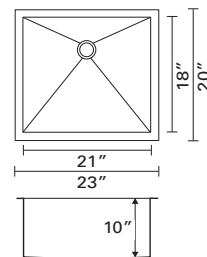

SQ1700

SIZE:

19" x 20"
(482mm x 508mm)

DEPTH: 10" (254mm)

FINISH: Satin

Optional Accessories:

GR1817SQ BA1809 BA1811 CB18

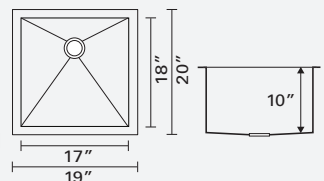

SQ2300

SIZE:

25" x 20"
(635mm x 508mm)

DEPTH: 10" (254mm)

FINISH: Satin

Optional Accessories:

GR1823SQ BA1809 BA1811 CB18

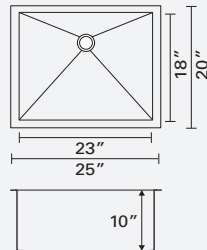

SQ19D6

SIZE:

21 1/4" x 17 1/2"
(540mm x 444mm)

DEPTH: 6 1/2" (165mm)

FINISH: Satin

Optional Accessories:

GR19D6SQ

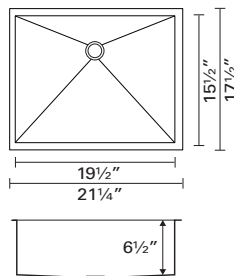
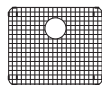

SQ2900

SIZE:

31" x 19"
(787mm x 482mm)

DEPTH: 10" (254mm)

FINISH: Satin

Optional Accessories:

GR1729 BA1709 BA1711 CB18

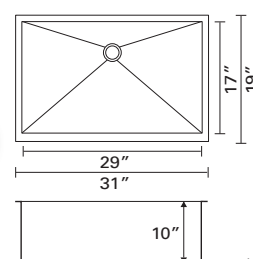

SQ1313

SIZE:

29" x 20"
(736mm x 508mm)

DEPTH: 10" (254mm)

FINISH: Satin

Optional Accessories:

GR1813SQ BA1809 BA1811 CB18

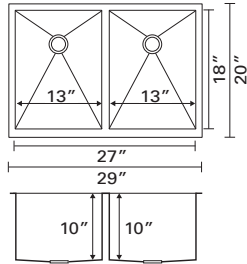

SQ1711

SIZE:

31" x 20"
(787mm x 508mm)

DEPTH:
Left bowl: 10" (254mm)
Right bowl: 8" (203mm)

FINISH: Satin

Optional Accessories:

GR1817SQ BA1809 BA1811 CB18

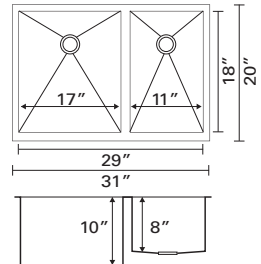

SQ1713

SIZE:

33" x 20"
(838mm x 508mm)

DEPTH: 10" (254mm)

FINISH: Satin

Optional Accessories:

GR1817SQ BA1809 BA1811 CB18

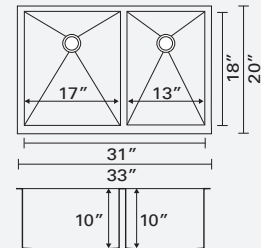

SQ1513

SIZE:

31" x 20"
(787mm x 508mm)

DEPTH: 10" (254mm)

FINISH: Satin

Optional Accessories:

GR1815SQ BA1809 BA1811 CB18

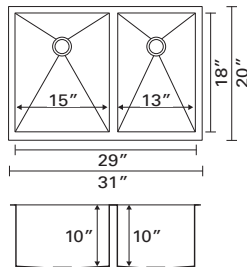

ZSSQ1200

SIZE:

14" x 18"
(355mm x 457mm)

DEPTH: 9" (228mm)

FINISH: Satin

Optional Accessories:

GR1612SQ BA1608 BA1610 CB16

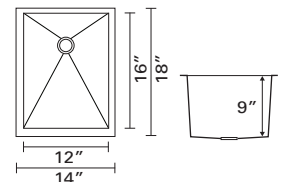

ZSSQ1500

SIZE:

17" x 18"
(431mm x 457mm)

DEPTH: 9" (228mm)

FINISH: Satin

Optional Accessories:

GR1615SQ BA1608 BA1610 CB16

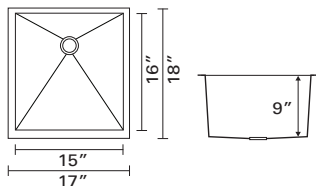

ZDSQ1509

SIZE:

27" x 18"
(685mm x 457mm)

DEPTH:

Left bowl: 9" (228mm)
Right bowl: 7" (178mm)

FINISH: Satin

Optional Accessories:

GR1615SQ BA1608 BA1610 CB16

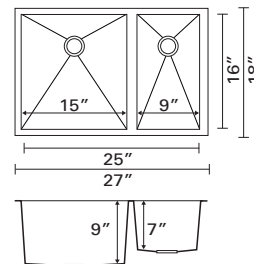

ZSSQ2200

SIZE:

24" x 18"
(609mm x 457mm)

DEPTH: 9" (228mm)

FINISH: Satin

Optional Accessories:

GR1622SQ BA1608 BA1610 CB16

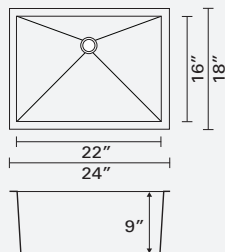

ZDSQ1212

SIZE:

27" x 18"
(685mm x 457mm)

DEPTH: 9" (228mm)

FINISH: Satin

Optional Accessories:

GR1612SQ BA1608 BA1610 CB16

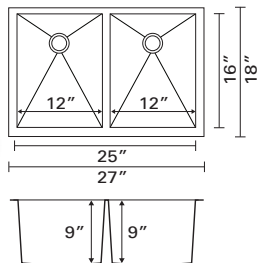

ZDSQ1512

SIZE:

30" x 18"
(762mm x 457mm)

DEPTH: 9" (228mm)

FINISH: Satin

Optional Accessories:

GR1615SQ BA1610 BA1608 CB16

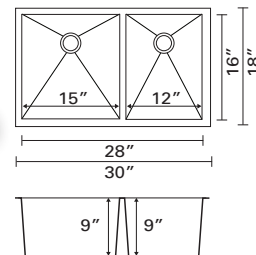

ZDSQ1909

SIZE:
31" x 18"
(787mm x 457mm)

DEPTH:
Left bowl: 9" (228mm)
Right bowl: 7" (178mm)

FINISH: Satin

Optional Accessories:
GR1619SQ BA1608 BA1610 CB16

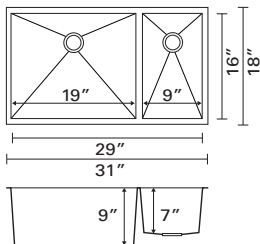

CSQ2800

SIZE:
30" x 18"
(762mm x 457mm)

DEPTH: 9" (228mm)

FINISH: Satin

Optional Accessories:
GRCC28 BA1608 BA1610 CB16

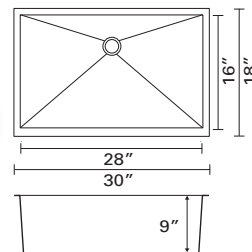

CSQ21D10

SIZE:
23" x 18"
(584.2mm x 457.2mm)

DEPTH: 10" (254mm)

FINISH: Satin

Optional Accessories:
GRCC21 BA1608 BA1610 CB16

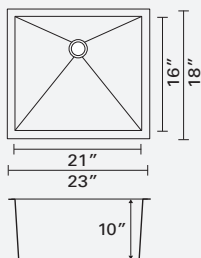

CSQ1414

SIZE:
30½" x 18"
(774mm x 457mm)

DEPTH: 9" (228mm)

FINISH: Satin

Optional Accessories:
GRCC14 BA1608 BA1610 CB16

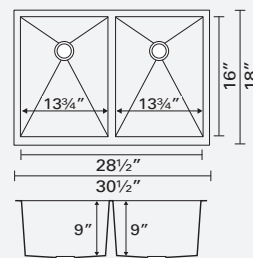

CSQ23D09

SIZE:
25" x 18"
(635mm x 457.2mm)

DEPTH: 9" (228mm)

FINISH: Satin

Optional Accessories:
GRCC23 BA1608 BA1610 CB16

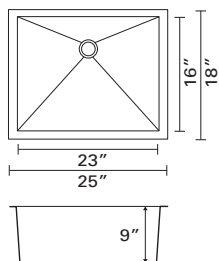

CSQ1612

SIZE:
31" x 18"
(787mm x 457mm)

DEPTH: 9" (228mm)

FINISH: Satin

Optional Accessories:
GRCC12 GRCC16 BA1610 BA1608 CB16

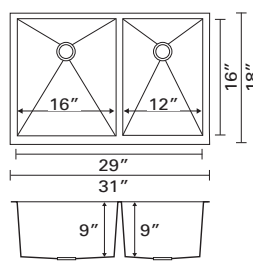



GEMINI BRAND

ROUND CORNER SQUARE SINK

RC1300

SIZE:
15" x 19"
(381mm x 482mm)
DEPTH: 10" (254mm)
FINISH: Satin

Optional Accessories:
GR1713RC BA1709
BA1711

CB17

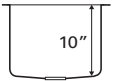
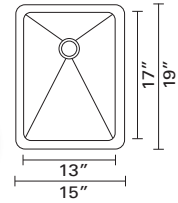

CBRC11

SIZE:
13" x 15"
(330mm x 381mm)
DEPTH: 6½" (165mm)
FINISH: Satin

Optional Accessories:

GR1311

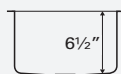
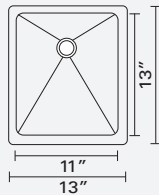

RC1500

SIZE:
17" x 19"
(431mm x 482mm)
DEPTH: 10" (254mm)
FINISH: Satin

Optional Accessories:
GR1715RC BA1709
BA1711

CB17

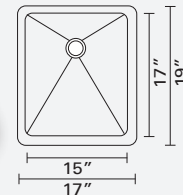
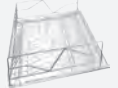

RC1100

SIZE:
13" x 19"
(330mm x 482mm)
DEPTH: 8" (203mm)
FINISH: Satin

Optional Accessories:

GR1711RC

BA1709

CB17

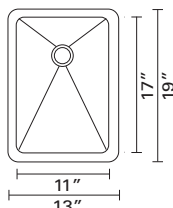

RC1700

SIZE:
19" x 19"
(482mm x 482mm)
DEPTH: 10" (254mm)
FINISH: Satin

Optional Accessories:
GR1717RC BA1709
BA1711

CB17

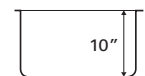
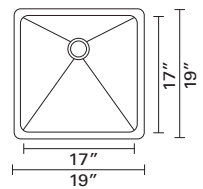

RC2100

SIZE:

23" x 19"
(584mm x 482mm)

DEPTH: 10" (254mm)

FINISH: Satin

Optional Accessories:

GR1721RC

BA1709

BA1711

CB17

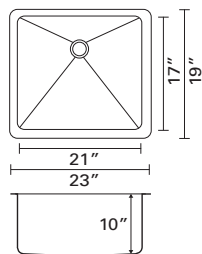

RC1313

SIZE:

29" x 19"
(584mm x 482mm)

DEPTH: 10" (254mm)

FINISH: Satin

Optional Accessories:

GR1713RC

BA1709

BA1711

CB17

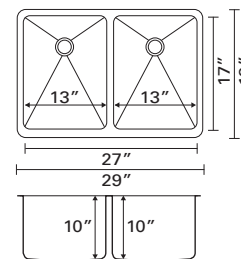

RC2300

SIZE:

25" x 19"
(635mm x 482mm)

DEPTH: 10" (254mm)

FINISH: Satin

Optional Accessories:

GR1723RC

BA1709

BA1711

CB17

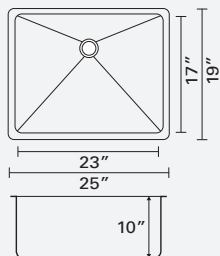
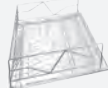
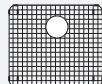

RC1513

SIZE:

31" x 19"
(787mm x 482mm)

DEPTH: 10" (254mm)

FINISH: Satin

Optional Accessories:

GR1715RC

BA1709

BA1711

CB17

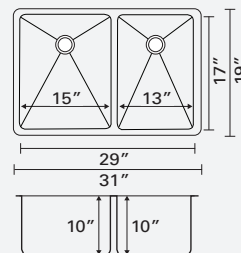

RC2900

SIZE:

31" x 19"
(787mm x 482mm)

DEPTH: 10" (254mm)

FINISH: Satin

Optional Accessories:

GR1729RC

BA1709

BA1711

CB17

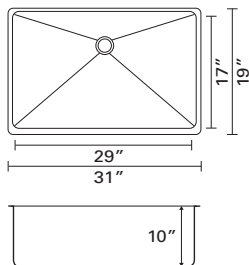
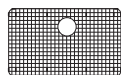

RC1711

SIZE:

31" x 19"
(787mm x 482mm)

DEPTH:
Left bowl: 10" (254mm)
Right bowl: 8" (203mm)

FINISH: Satin

Optional Accessories:

GR1717RC

BA1709

GR1711RC

BA1711

CB17

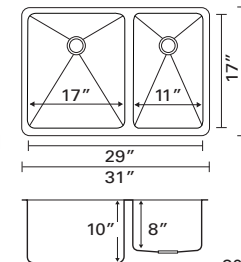

RC1713

SIZE:

33" x 19"
(838mm x 482mm)

DEPTH: 10" (254mm)

FINISH: Satin

Optional Accessories:

GR1717RC BA1709
GR1713RC BA1711 CB17

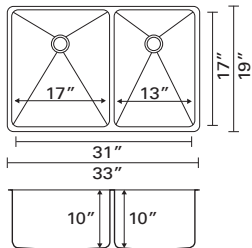

ZSRC1900

SIZE:

21" x 18"
(533.4mm x 457mm)

DEPTH: 9" (228mm)

FINISH: Satin

Optional Accessories:

GR1619 BA1608
BA1610 CB16

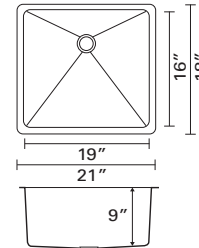

ZSRC1200

SIZE:

14" x 18"
(355.6mm x 457mm)

DEPTH: 9" (228mm)

FINISH: Satin

Optional Accessories:

GR1612SQ BA1608
BA1610 CB16

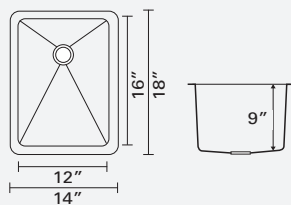

ZSRC1500

SIZE:

17" x 18"
(431.8mm x 457mm)

DEPTH: 9" (228mm)

FINISH: Satin

Optional Accessories:

GR1615RC BA1608
BA1610 CB16

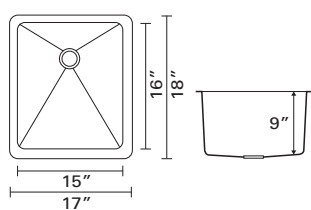

ZSRC2200

SIZE:

24" x 18"
(609.6mm x 457mm)

DEPTH: 9" (228mm)

FINISH: Satin

Optional Accessories:

GR1622SQ BA1608
BA1610 CB16

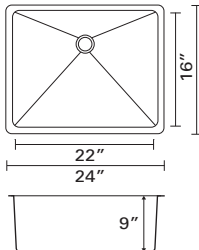

ZDRC1212

SIZE:

27" x 18"
(685.8mm x 457mm)

DEPTH: 9" (228mm)

FINISH: Satin

Optional Accessories:

GR1612SQ BA1608 BA1610 CB16

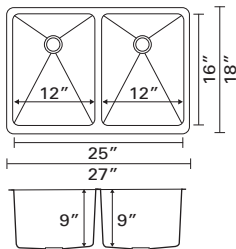

ZDRC1909

SIZE:

31" x 18"
(787.4mm x 457mm)

DEPTH:
Left bowl: 9" (228mm)
Right bowl: 7" (178mm)

FINISH: Satin

Optional Accessories:

GR1619SQ BA1608 BA1610 CB16

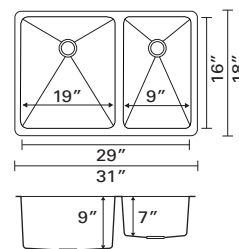

ZDRC1509

SIZE:

27" x 18"
(685.8mm x 457mm)

DEPTH:
Left bowl: 9" (228mm)
Right bowl: 7" (178mm)

FINISH: Satin

Optional Accessories:

GR1615SQ BA1608 BA1610 CB16

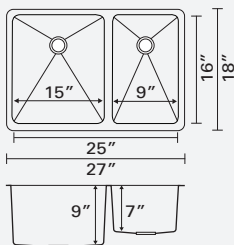

CRC23D09

SIZE:

25" x 18"
(635mm x 457.2mm)

DEPTH: 9" (228mm)

FINISH: Satin

Optional Accessories:

GRCC23 BA1608 BA1610 CB16

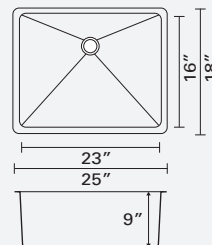

ZDRC1512

SIZE:

30" x 18"
(762mm x 457mm)

DEPTH: 9" (228mm)

FINISH: Satin

Optional Accessories:

GR1612SQ BA1608 GR1615SQ BA1610 CB16

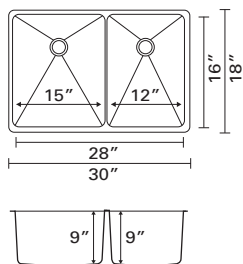

CRC21D10

SIZE:

23" x 18"
(431mm x 482mm)

DEPTH: 10" (254mm)

FINISH: Satin

Optional Accessories:

GRCC21 BA1608 BA1610 CB16

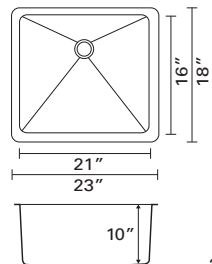

CRC2800

SIZE:

30" x 18"
(762mm x 457mm)

DEPTH: 9" (228mm)

FINISH: Satin

Optional Accessories:

GRCC28 BA1608 BA1610 CB16

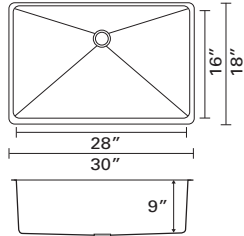

CRC1515

SIZE:

33" x 18"
(838mm x 457mm)

DEPTH: 9" (228mm)

FINISH: Satin

Optional Accessories:

GR1615SQ BA1608 BA1610 CB16

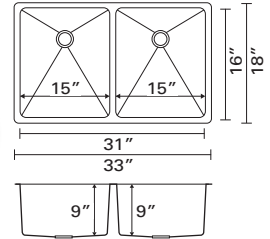

CRC1414

SIZE:

30½" x 18"
(774mm x 457mm)

DEPTH: 9" (228mm)

FINISH: Satin

Optional Accessories:

GRCC14 BA1608 BA1610 CB16

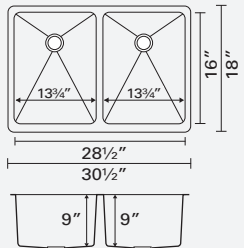

CRC1614

SIZE:

32¾" x 18"
(832mm x 457mm)

DEPTH: 9" (228mm)

FINISH: Satin

Optional Accessories:

GRCC14 GRCC16 BA1608 BA1610 CB16

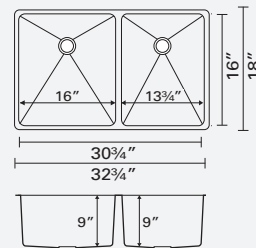

CRC1612

SIZE:

31" x 18"
(787mm x 457mm)

DEPTH: 9" (228mm)

FINISH: Satin

Optional Accessories:

GRCC12 GRCC16 BA1608 BA1610 CB16

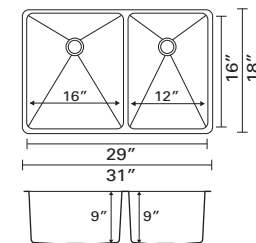

CRC16P

SIZE:
30" x 21"
(762mm x 533mm)

DEPTH:
Left bowl: 9" (228mm)
Right bowl: 6½" (165mm)

FINISH: Satin

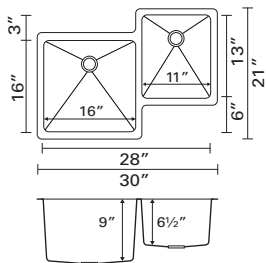

CX1311

SIZE:
27" x 20"
(686mm x 508mm)

DEPTH:
Left bowl: 9" (228mm)
Right bowl: 7½" (190mm)

FINISH: Satin

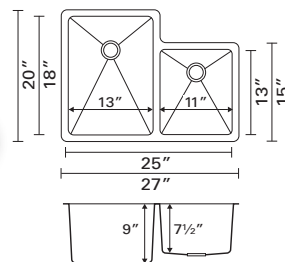

CRC19P

SIZE:
33" x 21"
(838mm x 533mm)

DEPTH:
Left bowl: 9" (228mm)
Right bowl: 6½" (165mm)

FINISH: Satin

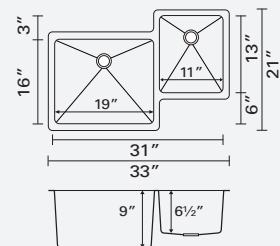

CX1511

SIZE:
29½" x 20"
(749mm x 508mm)

DEPTH:
Left bowl: 9" (228mm)
Right bowl: 7½" (190mm)

FINISH: Satin

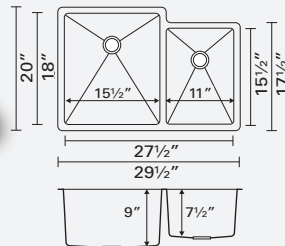

CRC21P

SIZE:
35" x 21"
(889mm x 510mm)

DEPTH:
Left bowl: 9" (228mm)
Right bowl: 6½" (165mm)

FINISH: Satin

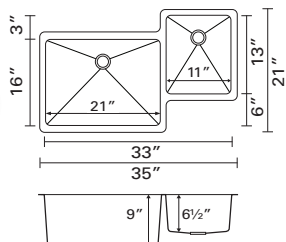

CX1513

SIZE:
31½" x 20"
(800mm x 508mm)

DEPTH:
Left bowl: 9" (228mm)
Right bowl: 7½" (190mm)

FINISH: Satin

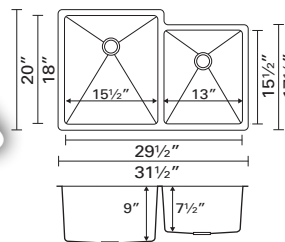

CX1711

SIZE:

31½" x 20"
(800mm x 508mm)

DEPTH:

Left bowl: 9" (228mm)
Right bowl: 7½" (190mm)

FINISH: Satin

Optional Accessories:

GR1511 BA1809
GR1817SQ BA1811 CB18

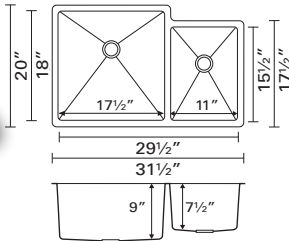

GEMINI BRAND APRON SINK

DM1515

SIZE:

33" x 19"
(838mm x 483mm)

DEPTH: 10" (254mm)

FINISH: Satin

Optional Accessories:

GR1715RC BA1709
BA1711 CB17

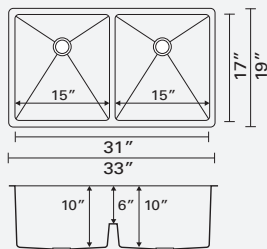

FM2900

SIZE:

32" x 20½"
(813mm x 546mm)

DEPTH: 10" (254mm)

FINISH: Satin

Optional Accessories:

GR1729 BA1709
BA1711 CB17

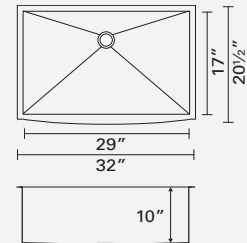

DM1713P

SIZE:

42¾" x 19"
(1086mm x 483mm)

DEPTH: 10" (254mm)

FINISH: Satin

Optional Accessories:

GR1713RC BA1709
GR1717RC BA1711 CB17

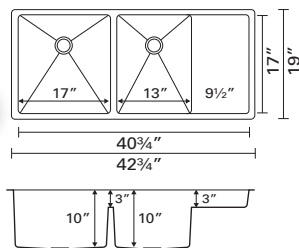

FM1313

SIZE:

30" x 21½"
(762mm x 546mm)

DEPTH: 10" (254mm)

FINISH: Satin

Optional Accessories:

GR1813SQ BA1809
BA1811 CB18

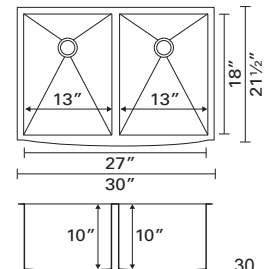

FM1513

SIZE:

32" x 21½"
(813mm x 546mm)

DEPTH: 10" (254mm)

FINISH: Satin

Optional Accessories:

GR1815SQ BA1809
GR1813SQ BA1811 CB18

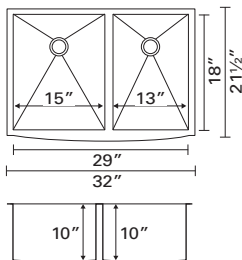

ZFM1509

SIZE:

28" x 19 5/8"
(711mm x 498mm)

DEPTH:
Left bowl: 9" (228mm)
Right bowl: 7" (178mm)

FINISH: Satin

Optional Accessories:

GR1615SQ BA1608
GR1612SQ BA1610 CB16

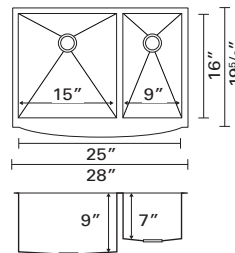

FM1711

SIZE:

32" x 21½"
(813mm x 546mm)

DEPTH:
Left bowl: 10" (254mm)
Right bowl: 8" (203mm)

FINISH: Satin

Optional Accessories:

GR1817SQ BA1809
GR1811SQ BA1811 CB18

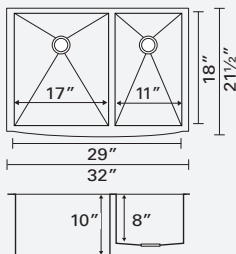

ZFM1512

SIZE:

31" x 19 5/8"
(787mm x 498mm)

DEPTH: 9" (228mm)

FINISH: Satin

Optional Accessories:

GR1615SQ BA1608
GR1612SQ BA1610 CB16

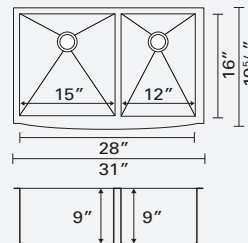

FM1713

SIZE:

34" x 21½"
(863mm x 546mm)

DEPTH: 10" (254mm)

FINISH: Satin

Optional Accessories:

GR1817SQ BA1809
GR1813SQ BA1811 CB18

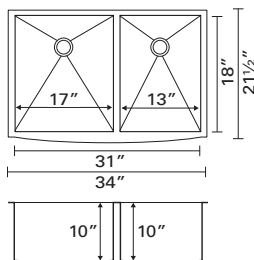

ZFM2200

SIZE:

25" x 19 5/8"
(635mm x 498mm)

DEPTH: 9" (228mm)

FINISH: Satin

Optional Accessories:

GR1622SQ BA1608
GR1610 BA1610 CB16

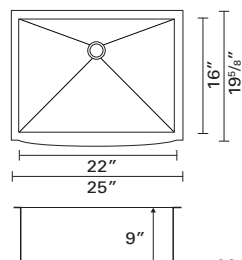



GEMINI BRAND

ROUND CORNER APRON SINK

RCFM1513

SIZE:
32" x 20 1/2"
(813mm x 546mm)
DEPTH: 10" (254mm)
FINISH: Satin

Optional Accessories:
GR1713RC BA1709 CB17
GR1715RC BA1711

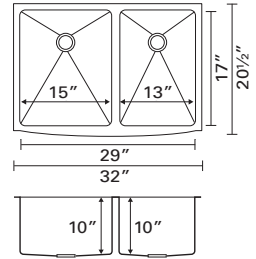

RCFM2900

SIZE:
32" x 20 1/2"
(813mm x 546mm)
DEPTH: 10" (254mm)
FINISH: Satin

Optional Accessories:
GR1729 BA1709 CB17
BA1711

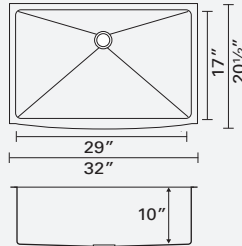

RCFM1711

SIZE:
32" x 20 1/2"
(813mm x 546mm)
DEPTH:
Left bowl: 10" (254mm)
Right bowl: 8" (203mm)
FINISH: Satin

Optional Accessories:
GR1711RC BA1709 CB17
GR1717RC BA1711

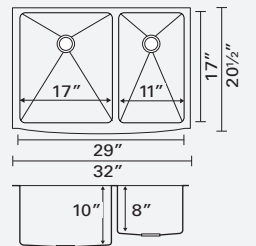

RCFM1313

SIZE:
30" x 20 1/2"
(762mm x 546mm)
DEPTH: 10" (254mm)
FINISH: Satin

Optional Accessories:
GR1713RC BA1709 CB17
BA1711

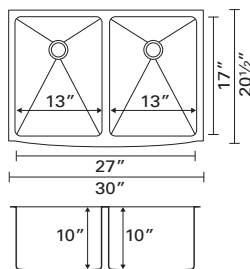

RCFM1713

SIZE:
34" x 20 1/2"
(863.6mm x 546mm)
DEPTH: 10" (254mm)
FINISH: Satin

Optional Accessories:
GR1713RC BA1709 CB17
GR1717RC BA1711

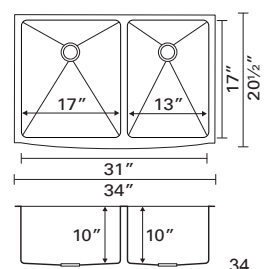

ZRCFM1509

SIZE:

28" x 19 5/8"
(711mm x 498mm)

DEPTH:

Left bowl: 9" (228mm)
Right bowl: 7" (178mm)

FINISH: Satin

Optional Accessories:

GR1615SQ BA1608
BA1610 CB16

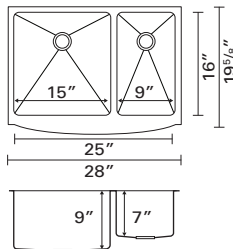

ZRCFM1512

SIZE:

31" x 19 5/8"
(787mm x 498mm)

DEPTH: 9" (228mm)

FINISH: Satin

Optional Accessories:

GR1612SQ BA1608
GR1615SQ BA1610 CB16

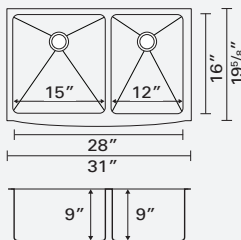

ZRCFM2200

SIZE:

25" x 19 5/8"
(635mm x 498mm)

DEPTH: 9" (228mm)

FINISH: Satin

Optional Accessories:

GR1622SQ BA1608
BA1610 CB16

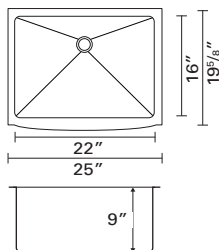

CRC13G Corner Sink

SIZE:

27 3/4" x 23"
(679mm x 584mm)

DEPTH:

Left bowl: 6 1/2" (165mm)
Right bowl: 9" (228mm)

FINISH: Satin

Optional Accessories:

GR1311 BA1608
GRCC14 BA1610 CB16

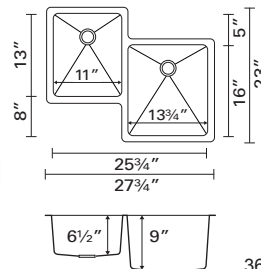

GEMINI BRAND

CORNER SINK

AG1616 Corner Sink

SIZE:

27" x 27"
(686mm x 686mm)

DEPTH: 9" (228mm)

FINISH: Satin

Optional Accessories:

GR16

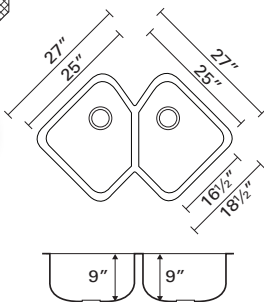

GEMINI BRAND

LAUNDRY SINK

AG1616H Corner Sink

SIZE:

27" x 27"
(686mm x 686mm)

DEPTH: 9" (228mm)

FINISH: Satin

Optional Accessories:

GR16

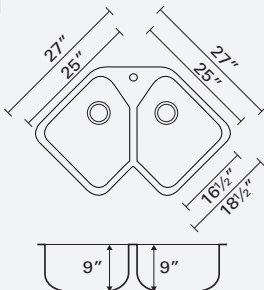

ZSRC21D13 Laundry Sink

SIZE:

23" x 19"
(584mm x 483mm)

DEPTH: 13" (330mm)

FINISH: Satin

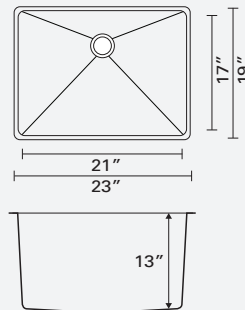

RCT21D13 Laundry Sink Topmount

SIZE:

23" x 19"
(584mm x 482.6mm)

DEPTH: 13" (330mm)

FINISH: Satin

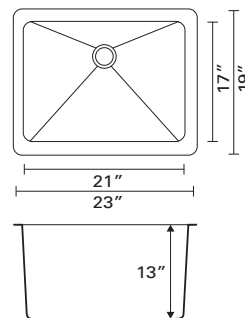



GEMINI BRANDS

GE SERIES UNDER MOUNT

Features

- Type 304 Stainless Steel, sink of 18 gauge (1.2mm) with 18/10 chrome- nickel content for exceptional lustre and durability
- Silk rim and classic satin finish bowl
- Fully undercoated and insulated with sound pads for a softer sounding kitchen
- Visually striking undermount installation allows for easy cleaning and creates an integrated look
- Drain opening: 3 1/2(89mm)
- Custom Accessories



Classic Satin Finish

High-End Baffle Edge

Installation

- Template and installation clips are packed with every sink

Standard

- All our sinks are approved with C/US certification

Warranty

- Lifetime limited buyer warranty to be free of all manufacturing defects under normal use

GE202

SIZE:

28" x 18 3/8"
(711mm x 466mm)

DEPTH:

Left bowl: 8" (203mm)
Right bowl: 7" (178mm)

FINISH: Classic Satin

Optional Accessories:

GR02



GR13

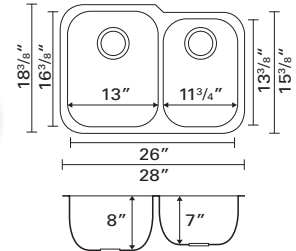

GE216

SIZE:

30 5/8" x 18"
(777mm x 457mm)

DEPTH: 9" (228mm)

FINISH: Classic Satin

Optional Accessories:

GR16Z14

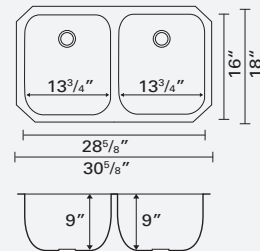

GE303

SIZE:

29 1/2" x 20 1/2"
(750mm x 520mm)

DEPTH:

Left bowl: 9" (228mm)
Right bowl: 7 1/2" (190mm)

FINISH: Classic Satin

Optional Accessories:

GR01



GR72

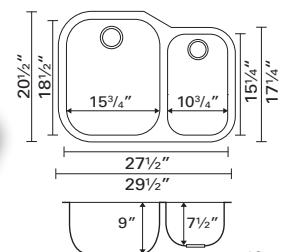

GE301

SIZE:

31 15/16" x 20 11/16"
(810mm x 525mm)

DEPTH:

Left bowl: 9" (228mm)
Right bowl: 8" (203mm)

FINISH: Classic Satin

Optional Accessories:

GR01

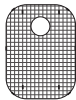

GR02

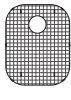

GE501

SIZE:

29 1/8" x 18 5/8"
(711mm x 466mm)

DEPTH: 8" (203mm)

FINISH: Classic Satin

Optional Accessories:

GR02

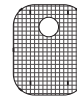

GE301R

SIZE:

31 15/16" x 20 11/16"
(810mm x 525mm)

DEPTH:

Left bowl: 8" (203mm)
Right bowl: 9" (228mm)

FINISH: Classic Satin

Optional Accessories:

GR02



GR01

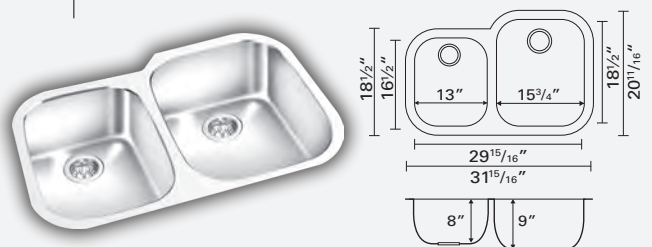
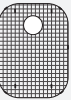

GE401

SIZE:

34 5/8" x 20 11/16"
(878mm x 525mm)

DEPTH: 9" (228mm)

FINISH: Classic Satin

Optional Accessories:

GR01



GE505

SIZE:

26 3/4" x 18 1/2"
(680mm x 470mm)

DEPTH:

Left bowl: 8" (203mm)
Right bowl: 7 1/2" (190mm)

FINISH: Classic Satin

Optional Accessories:

GR02



GR72



GE605

SIZE:

38½" x 20"
(980mm x 510mm)

DEPTH: 9" (228mm)

FINISH: Classic Satin

Optional Accessories:

GR06R

GR06

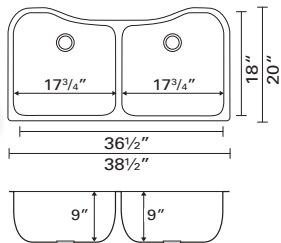

GE601R

SIZE:

33¾" x 20"
(857mm x 508mm)

DEPTH:
Left bowl: 8" (203mm)
Right bowl: 9" (228mm)

FINISH: Classic Satin

Optional Accessories:

GR02

GR06R

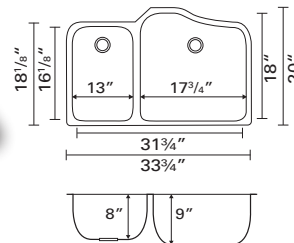

GE607

SIZE:

31" x 18"
(787mm x 457mm)

DEPTH: 9" (228mm)

FINISH: Classic Satin

Optional Accessories:

GR66R

GR66

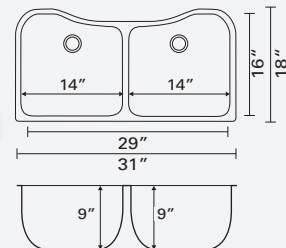

GE601

SIZE:

33¾" x 20"
(857mm x 508mm)

DEPTH:
Left bowl: 9" (228mm)
Right bowl: 8" (203mm)

FINISH: Classic Satin

Optional Accessories:

GR06

GR02

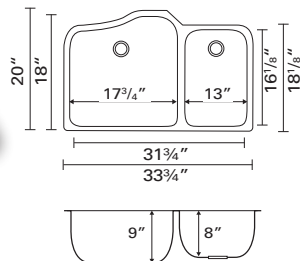

GE602

SIZE:

31½" x 20"
(800mm x 508mm)

DEPTH:
Left bowl: 9" (228mm)
Right bowl: 7½" (190mm)

FINISH: Classic Satin

Optional Accessories:

GR06

GR72

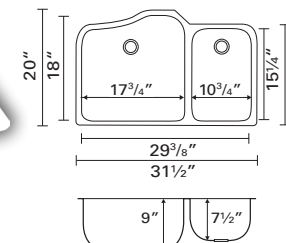

GE602R

SIZE:

31½" x 20"
(800mm x 508mm)

DEPTH:

Left bowl: 7½" (190mm)
Right bowl: 9" (228mm)

FINISH: Classic Satin

Optional Accessories:

GR72

GR06R

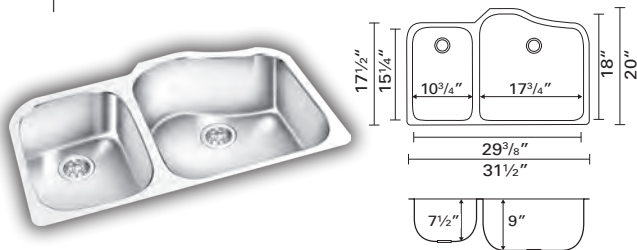
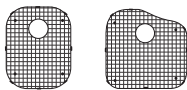

GE701R

SIZE:

31½" x 20 ⅞"
(800mm x 510mm)

DEPTH:

Left bowl: 7½" (190mm)
Right bowl: 9" (228mm)

FINISH: Classic Satin

Optional Accessories:

GR72

GR07

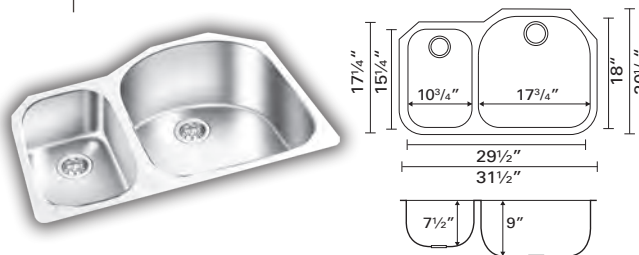
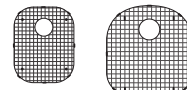

GE608

SIZE:

31" x 18"
(787mm x 457mm)

DEPTH: 9" (228mm)

FINISH: Classic Satin

Optional Accessories:

GR66

GR66R

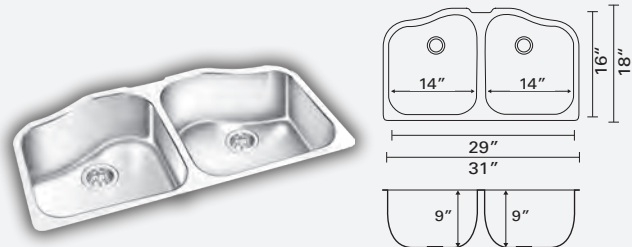

GE707

SIZE:

33 ¾" x 20 ⅞"
(857mm x 508mm)

DEPTH:

Left bowl: 9" (228mm)
Right bowl: 8" (203mm)

FINISH: Classic Satin

Optional Accessories:

GR07

GR02

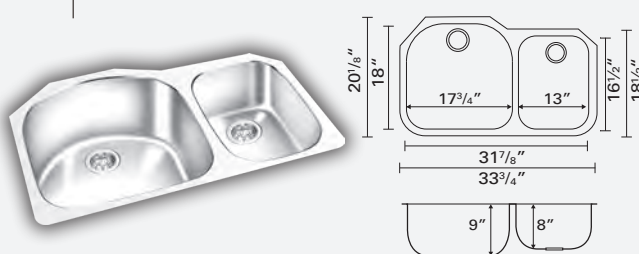
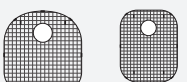

GE701

SIZE:

31½" x 20 ⅞"
(800mm x 510mm)

DEPTH:

Left bowl: 9" (228mm)
Right bowl: 7½" (190mm)

FINISH: Classic Satin

Optional Accessories:

GR07

GR72

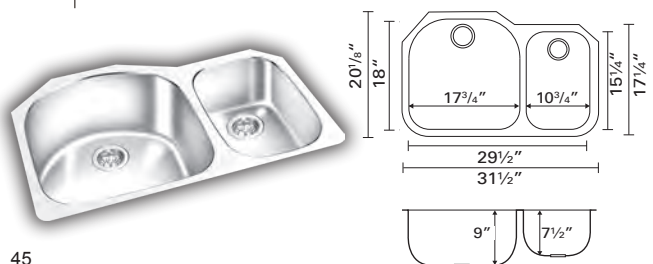
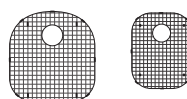

GE801

SIZE:

35½" x 21"
(900mm x 533mm)

DEPTH:

Left bowl: 9" (228mm)
Right bowl: 7½" (190mm)

FINISH: Classic Satin

Optional Accessories:

GR08

GR72

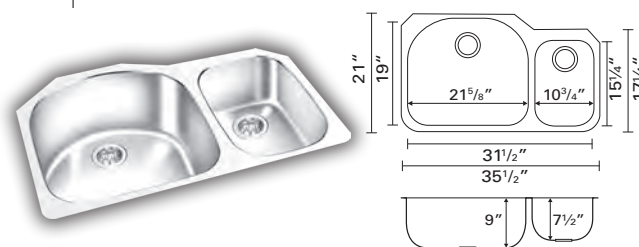
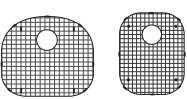

GE503

SIZE:

42 1/8" x 18 1/2"
(1070mm x 470mm)

DEPTH:

Left/Right bowl: 8" (203mm)
Centre bowl: 7" (178mm)

FINISH: Classic Satin

Optional Accessories:

GR02



GR13

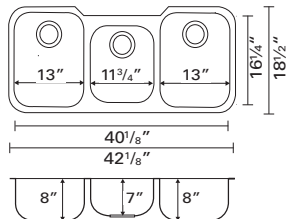

GE661466

SIZE:

39 5/16" x 18"
(998mm x 457mm)

DEPTH:

Left/Right bowl: 9" (228mm)
Centre bowl: 6" (152mm)

FINISH: Classic Satin

Optional Accessories:

GR66



GR66R

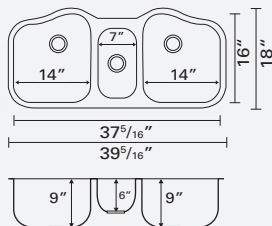

KM721472

SIZE:

32 3/8" x 17 3/8"
(822mm x 441mm)

DEPTH:

Left/Right bowl: 7 1/2" (190mm)
Centre bowl: 6" (152mm)

FINISH: Classic Satin

Optional Accessories:

GR72

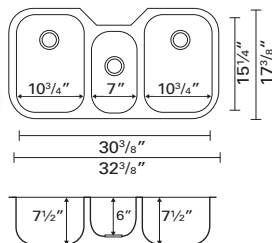

GEMINI BRANDS

KM SERIES UNDER MOUNT

KM series caters to the requests of an ever-growing clientele. Based on quality, availability and warranty.



Classic Satin Finish



High-End Baffle Edge

KM609

SIZE:

28" x 18"
(711mm x 457mm)

DEPTH:

Left bowl: 9" (228mm)
Right bowl: 6½" (165mm)

FINISH: Classic Satin

Optional Accessories:

GR66 GR11Z12

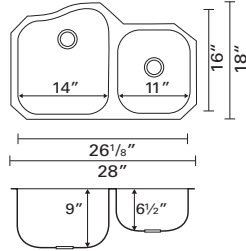
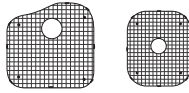

KM1614

SIZE:

24" x 18"
(610mm x 460mm)

DEPTH:

Left bowl: 8" (203mm)
Right bowl: 6" (150mm)

FINISH: Classic Satin

Optional Accessories:

GR16Z14

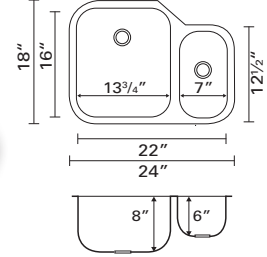

KM609R

SIZE:

28" x 18"
(711mm x 457mm)

DEPTH:

Left bowl: 6½" (165mm)
Right bowl: 9" (228mm)

FINISH: Classic Satin

Optional Accessories:

GR11Z12 GR66R

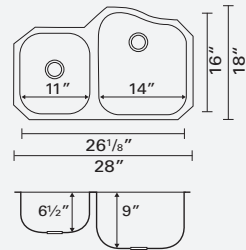

KM1615

SIZE:

28" x 18"
(711mm x 460mm)

DEPTH:

Left bowl: 8" (203mm)
Right bowl: 6½" (165mm)

FINISH: Classic Satin

Optional Accessories:

GR16Z14 GR11Z12

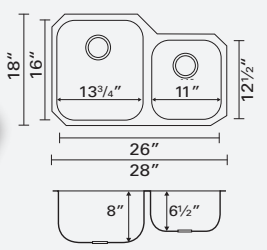

KM1612

SIZE:

27" x 18 1/8"
(686mm x 460mm)

DEPTH:

Left bowl: 8" (203mm)
Right bowl: 7½" (190mm)

FINISH: Classic Satin

Optional Accessories:

GR16Z14

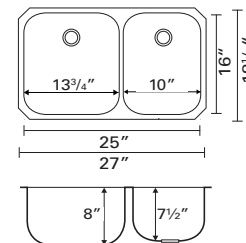

KM7272

SIZE:

24½" x 17 3/8"
(622mm x 441mm)

DEPTH:

7½" (190mm)

FINISH: Classic Satin

Optional Accessories:

GR72

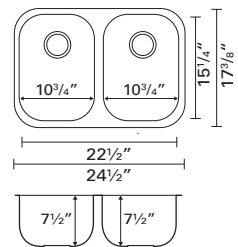



GEMINI BRANDS

GE SERIES UNDER MOUNT



Classic Satin Finish



High-End
Baffle Edge

GE101

SIZE:

17 1/8" x 20"
(435mm x 508mm)

DEPTH: 9" (228mm)

FINISH: Classic Satin

Optional Accessories:

GR01

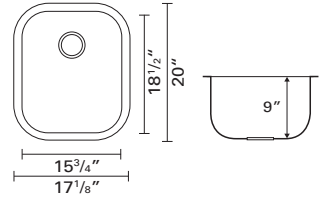

GE102

SIZE:

23 1/8" x 18 1/4"
(587mm x 464mm)

DEPTH: 9" (228mm)

FINISH: Classic Satin

Optional Accessories:

GR12

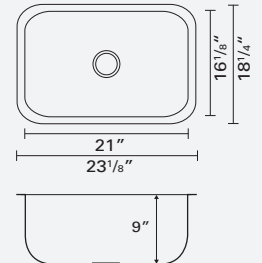
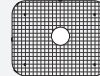

GE103

SIZE:

13 1/8" x 14 5/8"
(333mm x 371mm)

DEPTH: 7" (178mm)

FINISH: Classic Satin

Optional Accessories:

GR13

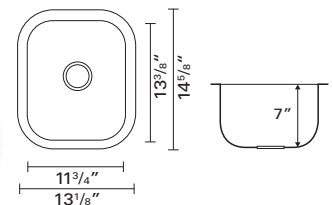

GE104

SIZE:

8 1/4" x 13 7/8"
(210mm x 352mm)

DEPTH: 6" (150mm)

FINISH: Classic Satin

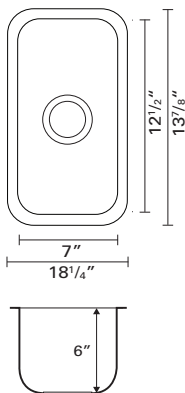

GE201

SIZE:

14 3/8" x 18"
(365mm x 457mm)

DEPTH: 8" (203mm)

FINISH: Classic Satin



Optional Accessories:

GR02

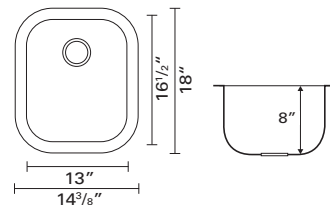

GE105

SIZE:

30" x 19"
(762mm x 482mm)

DEPTH: 9" (228mm)

FINISH: Classic Satin

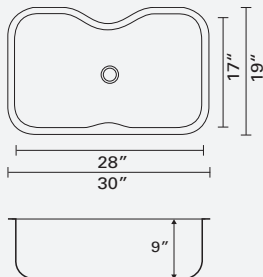

GE204

SIZE:

17" (430mm)

DEPTH: 7 1/2" (190mm)

FINISH: Classic Satin



Optional Accessories:

GR24

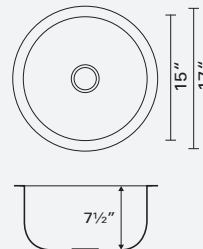

GE108

SIZE:

30" x 18 1/8"
(761mm x 460mm)

DEPTH: 9" (228mm)

FINISH: Classic Satin

Optional Accessories:

GR18

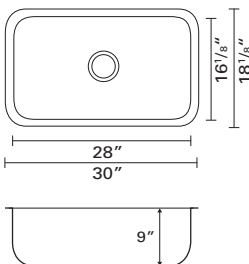
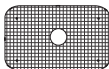

GE603

SIZE:

19 1/4" x 19 11/16"
(490mm x 500mm)

DEPTH: 9" (228mm)

FINISH: Classic Satin

Optional Accessories:

GR06

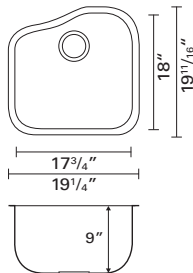

GE702

SIZE:

12" x 16 3/8"
(304mm x 416mm)

DEPTH: 7 1/2" (190mm)

FINISH: Classic Satin

Optional Accessories:

GR72

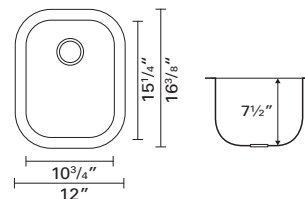

GE603R

SIZE:

19 1/4" x 19 11/16"
(490mm x 500mm)

DEPTH: 9" (228mm)

FINISH: Classic Satin

Optional Accessories:

GR06R

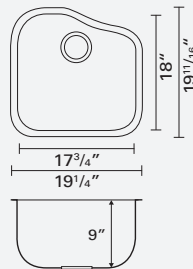

GE703

SIZE:

19" x 19 3/8"
(482mm x 492mm)

DEPTH: 9" (228mm)

FINISH: Classic Satin

Optional Accessories:

GR07

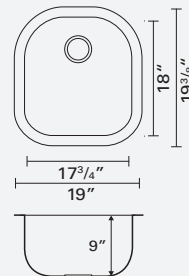

GE2518

SIZE:

22" x 18 1/2"
(560mm x 450mm)

DEPTH: 8" (203mm)

FINISH: Classic Satin

Optional Accessories:

GR08

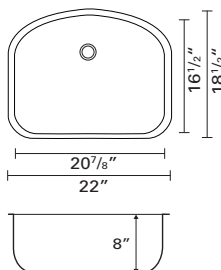

GE803

SIZE:

23 5/8" x 21"
(600mm x 532mm)

DEPTH: 10" (254mm)

FINISH: Classic Satin

Optional Accessories:

GR08

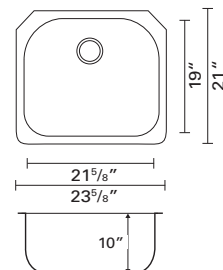



GEMINI BRANDS

TOP MOUNT SINKS

Features

- Type 304 Stainless Steel, sink of 18 gauge with 18/10 chrome-nickel content
- Self rim and classic satin finish bowl
- Fully undercoated and insulated with sound pads for a softer sounding kitchen
- Deck accommodates additional hole(s)
- Deep recessed sink rim prevents spillovers
- Drain opening: 3-1/2" (88mm)



Classic Satin Finish



High-End Baffle Edge

Installation

- Template and installation clips are packed with every sink

Standard

- All our sinks are approved with C/US certification

Warranty

- Lifetime limited buyer warranty to be free of all manufacturing defects under normal use

T01

SIZE:

21" x 21 7/8"
(533mm x 549mm)

DEPTH: 9" (228mm)

FINISH:

Self rim and classic satin
Deck accommodated 3 holes

Optional Accessories:

GR18Z16

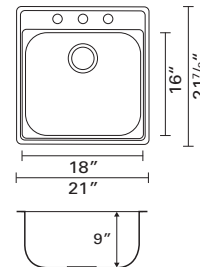

T02

SIZE:

32 3/4" x 22 1/8"
(831mm x 562mm)

DEPTH: 8" (203mm)

FINISH:

Self rim and classic satin
Deck accommodated 3 holes

Optional Accessories:

GR16Z14

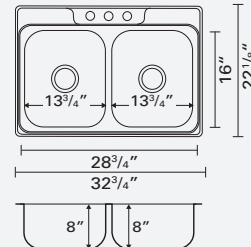

T03

SIZE:

33" x 22"
(838mm x 559mm)

DEPTH:

Left bowl: 9" (228mm)
Right bowl: 8" (203mm)

FINISH:

Self rim and classic satin
Deck accommodated 1 hole

Optional Accessories:

GR01

GR02

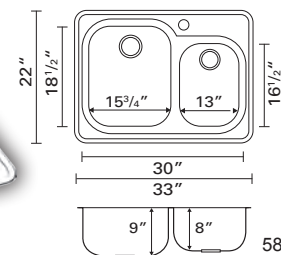
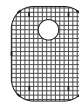
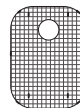

T05

SIZE:

30" x 19 1/8"
(762mm x 486mm)

DEPTH: 8" (203mm)

FINISH:

Self rim and classic satin
Deck accommodated 1 holes

Optional Accessories:

GR02

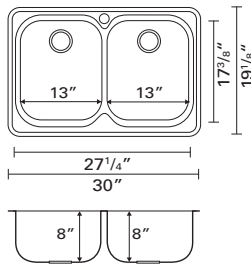

T07

SIZE:

32 3/4" x 21 1/2"
(831mm x 546mm)

DEPTH:

Left bowl: 9" (228mm)
Right bowl: 7 1/2" (190mm)

FINISH:

Self rim and classic satin
Deck accommodated 1 holes

Optional Accessories:

GR07

GR72

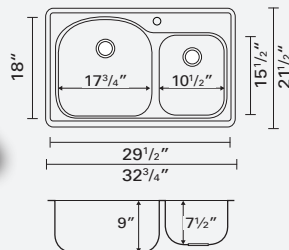

RNT1615

SIZE:

29 3/8" x 19 1/2"
(746mm x 495mm)

DEPTH:

Left bowl: 9" (228mm)
Right bowl: 7 1/2" (190mm)

FINISH:

Self rim and classic satin
Deck accommodated 1 holes

Optional Accessories:

GR16Z14

GR11Z12

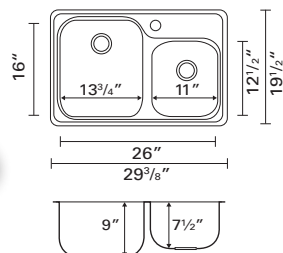

GEMINI BRANDS

COSMO UNDER & TOP MOUNT

Our creative and innovative approach to design, along with our attention to materials and manufacturing methods. COSMO Brands are affordable prices on a wide range of products.

Features

- Type 304 stainless steel with 18/10 chrome-nickel content
- Class satin finish
- Fully undercoated and insulated with sound pads for a softer sounding kitchen
- Drain opening: 3 1/2" (89mm)

Installation

- Template and installation clips are packed with every sink

Standard

- All our sinks are approved with C/US certification

Warranty

- Lifetime limited buyer warranty to be free of all manufacturing defects under normal use

CU1820

SIZE:

20" x 18 1/8"
(508mm x 460mm)

DEPTH: 9" (228mm)

FINISH: Classic Satin

Optional Accessories:

GR16Z18

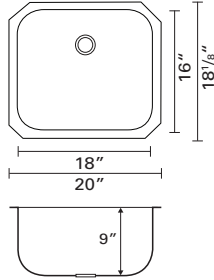

CU3118

SIZE:

30 7/8" x 18"
(784mm x 457mm)

DEPTH: 9" (228mm)

FINISH: Classic Satin

Optional Accessories:

GR16Z14

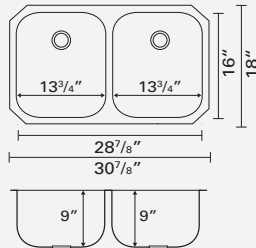

CU3518

SIZE:

35" x 18 1/8"
(889mm x 460mm)

DEPTH: 8" (203mm)

FINISH: Classic Satin

Optional Accessories:

GR16Z18

GR16Z14

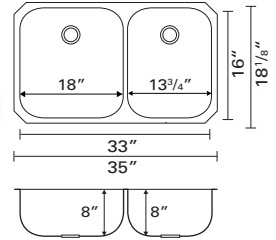

CU3020

SIZE:

30" x 20 1/8"
(762mm x 511mm)

DEPTH:

Left bowl: 9" (228mm)
Right bowl: 7 1/2" (190mm)

FINISH: Classic Satin

Optional Accessories:

GR18Z16

GR72

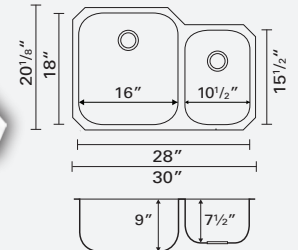

CU3320

SIZE:

33 1/8" x 20 1/8"
(841mm x 511mm)

DEPTH:

Left bowl: 9" (228mm)
Right bowl: 7 1/2" (190mm)

FINISH: Classic Satin

Optional Accessories:

GR18Z16

GR16Z14

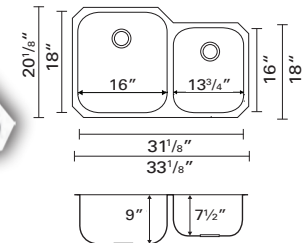

CU3220

SIZE:

31³/₄" x 20"
(806mm x 508mm)

DEPTH:

Left bowl: 9" (228mm)
Right bowl: 7¹/₂" (190mm)

FINISH: Classic Satin

Optional Accessories:

GR07



GR72

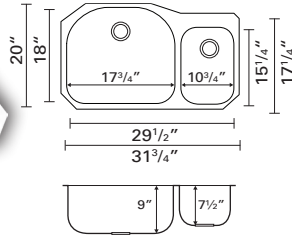

CT1515

SIZE:

14 ³/₈" x 15"
(365mm x 381mm)

DEPTH: 6" (150mm)

FINISH: Classic Satin

Optional Accessories:

GR11Z12

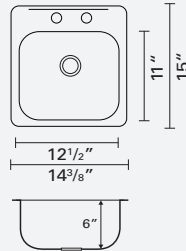

CT2720

SIZE:

27" x 20"
(685mm x 515mm)

DEPTH: 7¹/₂" (190mm)

FINISH: Classic Satin

Optional Accessories:

GR16Z14



GR16Z10

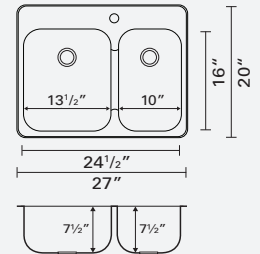

CT2120

SIZE:

20" x 20 ¹/₈"
(508mm x 511mm)

DEPTH: 7¹/₂" (190mm)

FINISH: Classic Satin

Optional Accessories:

GR16Z18

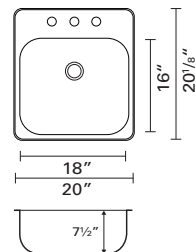

CT3120

SIZE:

31 ¹/₈" x 20 ¹/₂"
(790mm x 520mm)

DEPTH: 7¹/₂" (190mm)

FINISH: Classic Satin

Optional Accessories:

GR16Z14

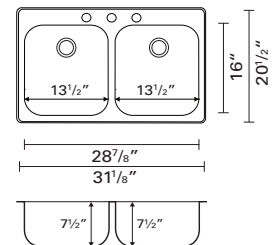



PROCELAIN SINK

Single Bowl

PROCELAIN SINK

W028

SIZE:

22 1/2" x 14 1/2"
(572mm x 368mm)

DEPTH: 6" (150mm)

INCLUDED IN BOX: Template

W028 White

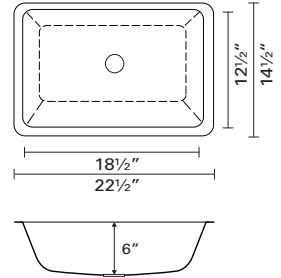

W183

MINIMUM CABINET SPACE:

17 1/2" x 14 1/2"
(445mm x 368mm)

DEPTH: 5 1/2" (140mm)

INCLUDED IN BOX: Template

W183 White

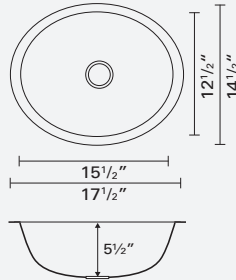

W036

SIZE:

22 1/2" x 14 1/2"
(572mm x 368mm)

DEPTH: 6 1/2" (165mm)

INCLUDED IN BOX: Template

W036 White

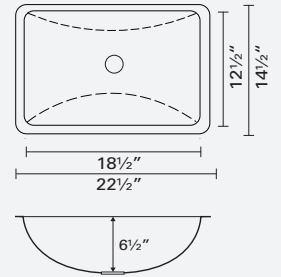

W210

MINIMUM CABINET SPACE:

19" x 16 1/4"
(483mm x 413mm)

DEPTH: 5 1/2" (140mm)

INCLUDED IN BOX: Template

W210 White

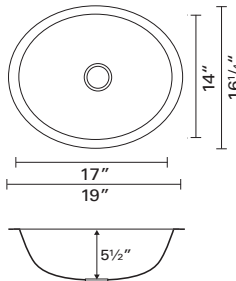

W068

SIZE:

19 1/2" x 15"
(495mm x 381mm)

DEPTH: 4 1/2" (114mm)

INCLUDED IN BOX: Template

W068 White

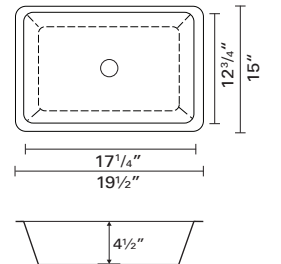



GEMINI BRAND

COMMERCIAL SINK

GE002

SIZE:

19 1/4" x 15"
(489mm x 381mm)

DEPTH: 5 1/4" (133mm)

FINISH: Classic Satin

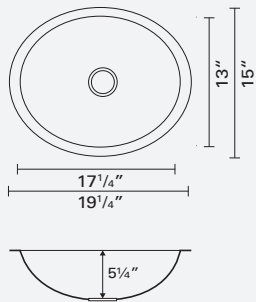

BRRC30

SIZE:

32" x 14"
(813mm x 356mm)

DEPTH: 6" (152mm)

FINISH: Satin

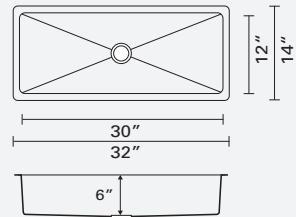

BRRC1812

SIZE:

20" x 14"
(560mm x 356mm)

DEPTH: 6" (152mm)

FINISH: Satin

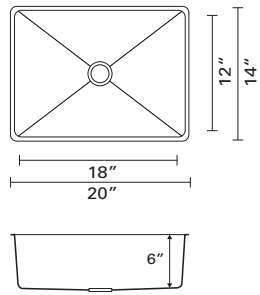

BRRC43

SIZE:

45" x 14"
(1143mm x 356mm)

DEPTH: 6" (152mm)

FINISH: Satin

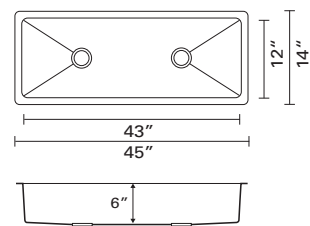

BRRC54

SIZE:

56" x 14"
(1422mm x 356mm)

DEPTH: 6" (152mm)

FINISH: Satin

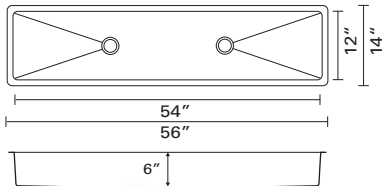

BRRC66

SIZE:

68" x 14"
(1727mm x 356mm)

DEPTH: 6" (152mm)

FINISH: Satin

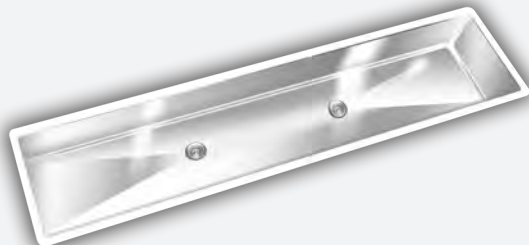
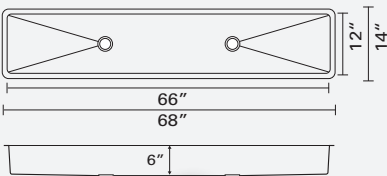

FSQ30

SIZE:

32" x 15"
(813mm x 381mm)

DEPTH: 7 1/2" (191mm)

FINISH: Satin

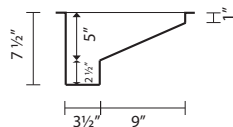
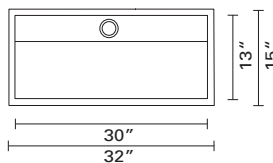

FSQ43

SIZE:

45" x 15"
(1143mm x 381mm)

DEPTH: 7 1/2" (191mm)

FINISH: Satin

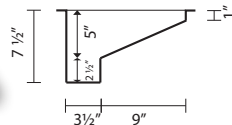
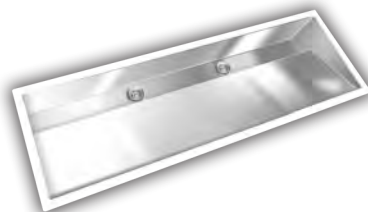
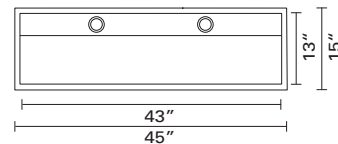

FSQ54

SIZE:

56" x 15"
(1422mm x 381mm)

DEPTH: 7 1/2" (191mm)

FINISH: Satin

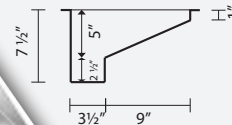
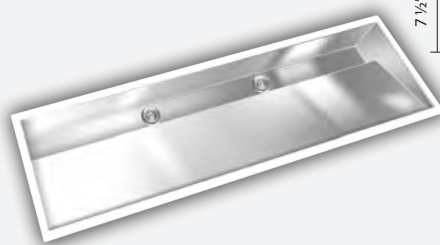
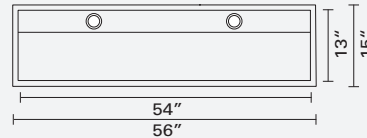

FSQ66

SIZE:

68" x 15"
(1727mm x 381mm)

DEPTH: 7 1/2" (191mm)

FINISH: Satin

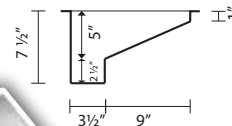
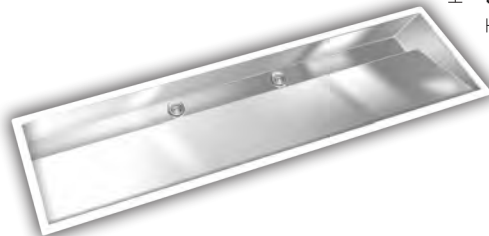
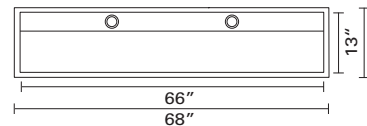

STAINLESS STEEL GRIDS

CUSTOM ACCESSORIES-GRIDS

Custom accessories are designed to fit and function perfectly with your sink and offer protection for your sink bowl surface from dishes and utensils. Same materials with our sinks, bottom grids with opening for sink drain. Refer to Run of Page, or website for relationship to GEMINI sinks models.

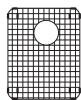

GRCC21

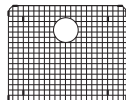

GR1619

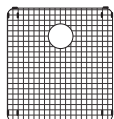

GRCC16



GRCC12

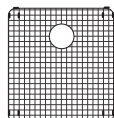

GRCC14

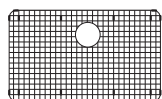

GRCC28

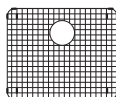

GR1722RC



GR1712RC

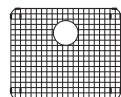

GRCC23

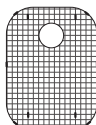

GR01

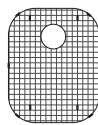

GR02

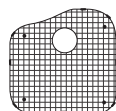

GR06

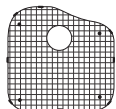

GR06R

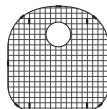

GR07

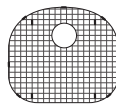

GR08

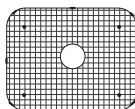

GR12

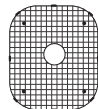

GR13

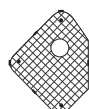

GR16

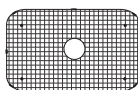

GR18

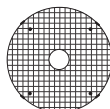

GR24

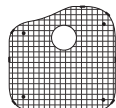

GR66

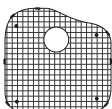

GR66R

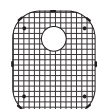

GR72

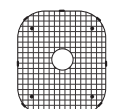

GR11Z12

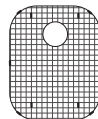

GR16Z10

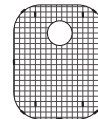

GR16Z14

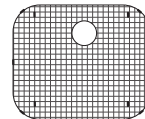

GR16Z18

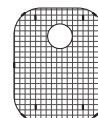

GR18Z16

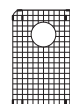

GR1811SQ

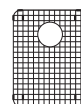

GR1813SQ

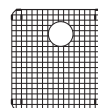

GR1815SQ

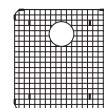

GR1817SQ

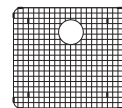

GR1821SQ

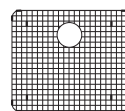

GR1823SQ

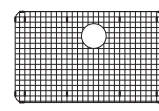

GR1729

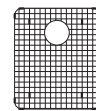

GR1612SQ

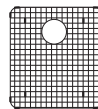

GR1615SQ

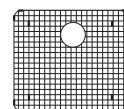

GR1622SQ

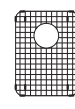

GR1711RC

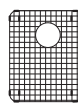

GR1713RC

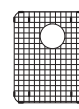

GR1715RC

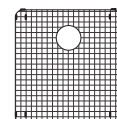

GR1717RC

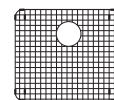

GR1721RC

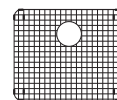

GR1723RC

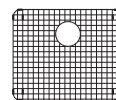

GR19D6SQ

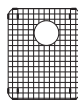

GR1511

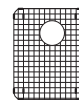

GR1513

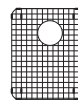

GR1311



BA1709



BA1711



BA1809



BA1811



BA1608



BA1610



STN0188



STN0184



CB SERIES

CB11 CB17
CB16 CB18

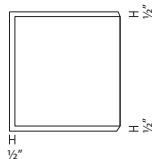

GEMINI

MORE ABOUT OUR SINKS

OUR SERVICE

■ CAD files: Gemini includes a physical template in every individually packaged sink. CAD files are available for off the website for precise, accurate cuts each and every time. CAD files also feature offset values for different styles of cuts. To partially reveal the sink rim, use the outside offset parameters. To cut the opening flush with sink bowl(s) use the center line. To leave a slight overhang into the sink bowl(s) , use the inside set of parameters. Cut-out drawings can be ordered. Please direct your enquiry to our customer service or download from our to our website www.geminisink.com. Please note that only a professional sink installer/fabricator process these DXF files for sink cutouts.

■ We can custom-made sinks you need. We have over 10 years of research, design and development experience which gives us the ability to release new and customized models in a short period of time.

WARRANTY

■ Lifetime Limited Buyer Warranty.

COMPETITIVE ADVANTAGES

■ Gemini® sinks are always in tune with market demands by supplying marble shop and plumbing boutiques with quality products and modern designs of what people are looking for. Stainless steel seems to be in trend now. Whether it is appliances to backsplashes to sinks, stainless steel seems to bring a touch of class and design to the kitchen.

■ Most of our sink are oversized that provide the most usable space to easily handle large pot and pans.

■ Our signature satin finish is our mark of excellence in the industry that separates our products from the rest. ALL Gemini stainless steel sinks have an astonishing brushed satin finish that leaves the sink breath taking for years to come.

■ All dimensions on the catalogue are nominal. Please make the object as the standard. Always keep updated with our newly launched website: www.geminisink.com. Visit us regularly and you will be able to follow the to market trends and new products ready for launch.